

COROWA SHIRE COUNCIL

DEVELOPMENT CONTROL PLAN NO. 16

1. Introduction

This is Corowa Development Control Plan No. 16. This Plan is prepared in accordance with the provisions of Section 72 of the Environmental Planning and Assessment Act, 1979 as amended and Clauses 16, 17 and 17A of the Environmental Planning and Assessment Regulations 2000.

This Plan was adopted by Council on 16 August 2005 and commences on that date.

2. Land To Which This Plan Applies

This Plan applies to the land situated in the Shire of Corowa legally known as Lot 2 DP 819938, being the land bound by thick black lines on the accompanying map.

3. Relationship To Other Environmental Planning Instruments

This Plan applies to land currently zoned Residential 2(a) under Corowa Local Environmental Plan 1989. This Plan conforms to the Local Planning Controls listed in Corowa Local Environmental Plan 1989.

4. Aims and Objectives

- 4.1 This Plan is to assist in meeting the aims and objectives of Corowa Local Environmental Plan 1989 by providing a subdivision design for the subject land within which future development can be accommodated.
- 4.2 The purpose of this Development Control Plan is to indicate a desirable pattern for future subdivision of the land to which this Plan applies. It is intended to provide a framework within which future residential development of the land can be made. The provision of infrastructure required for residential purpose, in the form of, roads, stormwater drainage, sewerage and recreation facilities, to that land.

5. Variation of this Plan

Variations to this Plan are to be made in accordance with the provisions of the Environmental Planning and Assessment Act 1979, as amended, and the Environmental Planning and Assessment Regulations 2000.

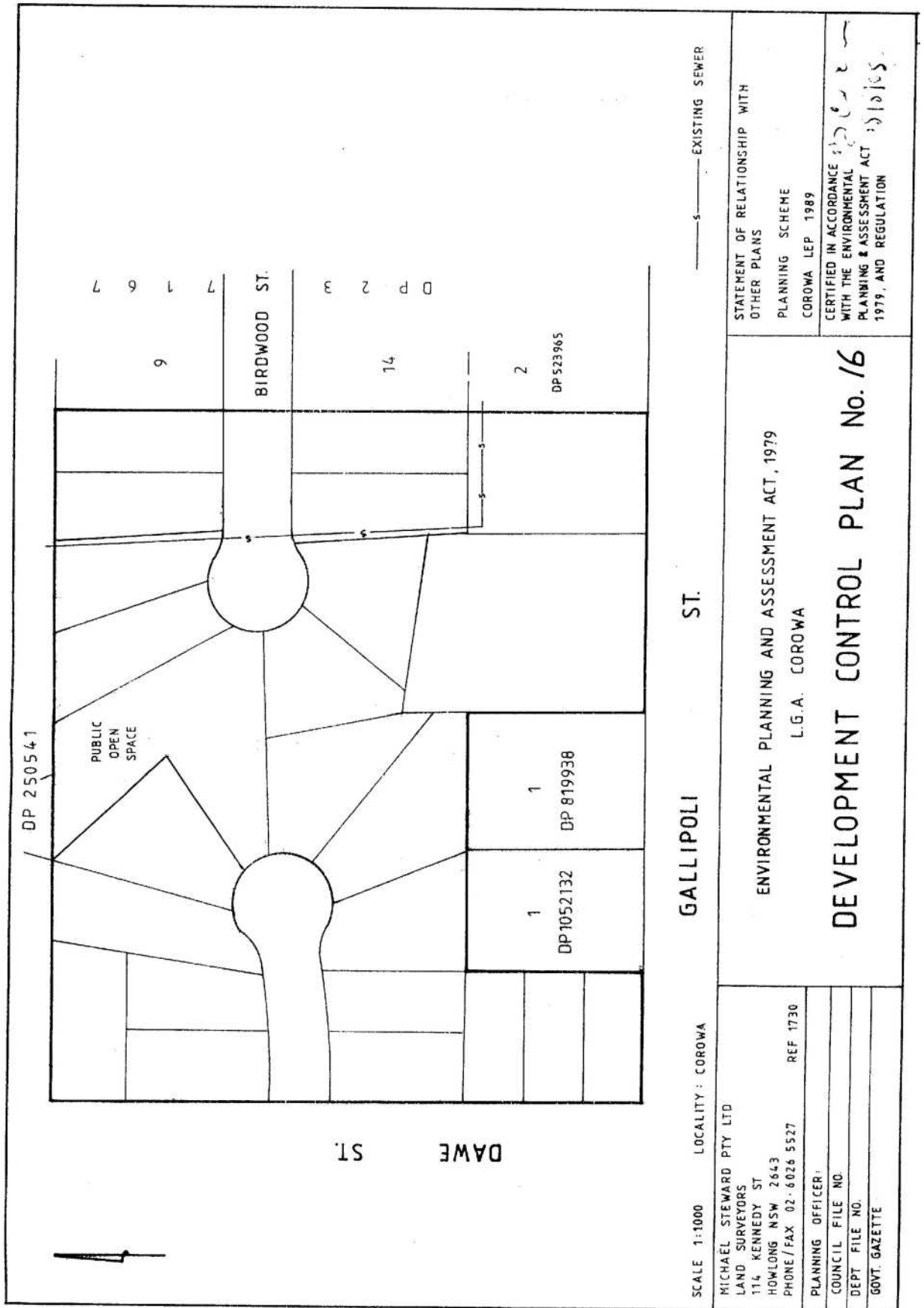

STATEMENT OF RELATIONSHIP WITH OTHER PLANS
 PLANNING SCHEME
 COROWA LEP 1989
 CERTIFIED IN ACCORDANCE WITH THE ENVIRONMENTAL PLANNING & ASSESSMENT ACT 1979, AND REGULATION

GALLIPOLI ST.
 ENVIRONMENTAL PLANNING AND ASSESSMENT ACT, 1979
 L.G.A. COROWA
DEVELOPMENT CONTROL PLAN No. 16

SCALE 1:1000 LOCALITY: COROWA
 MICHAEL STEWARD PTY LTD
 LAND SURVEYORS
 114 KENNEDY ST
 HOWLONG NSW 2643
 PHONE / FAX 02-6026 5527 REF 1730
 PLANNING OFFICER:
 COUNCIL FILE NO.
 DEPT FILE NO.
 GOVT. GAZETTE